

DAGGER DRONE

Full HD Drone

INSTRUCTIONS MANUAL

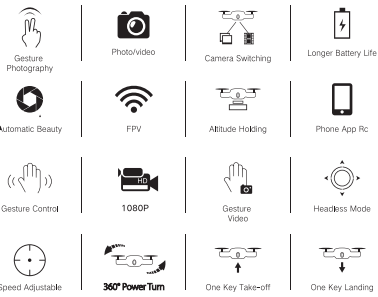
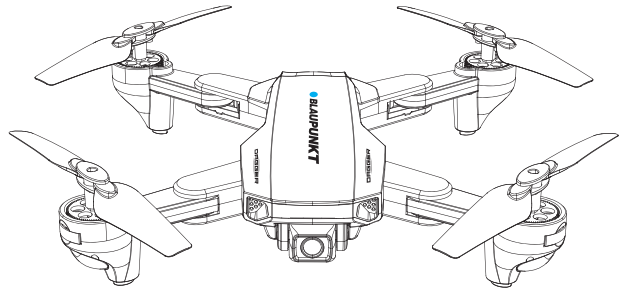

DISTRIBUIDO POR / DISTRIBUIDO POR
Argentina: Importa, distribuye y garantiza Someco Electronica S.A. CUIT: 30-70217915-3
Reconquista 336 - Piso 6 OF-65 - C 1003ABH - CABA - Republica Argentina Tel: (54-11) 4653-3333
Brasil: Importado e distribuido por SOMECO Ind. Com. Import. Export. Ltda. CNPJ: 01.872.488/0001-00 Origem China. Validade: Indeterminada.
Chile: Importa, distribuye y garantiza Electronica Megatel SA (Someco Andina), Povernin 140, Santiago Centro - Chile. contacto@somecoandina.cl

BLAUPUNKT

established

1924

GERMANY

PARTS DESCRIPTION

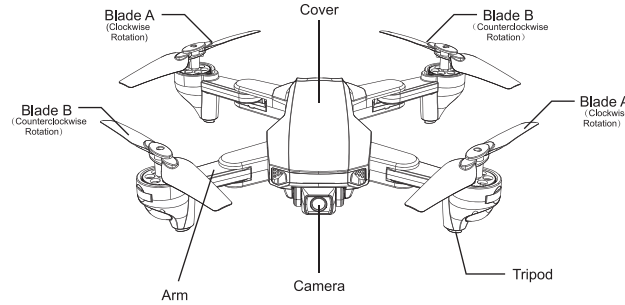

Note: photos are for reference only, please in kind prevail.

PARTS DESCRIPTION OF THE REMOTE CONTROLLER

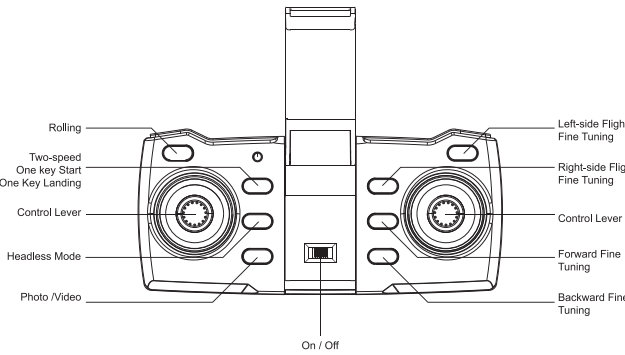

Low power indication: When the energy is lower than 3V , there is the warning tone of "Di, Di", it means user needs to change the new batteries.

Note: remote control design please in kind prevail, please according to the physical design keys corresponding to manual operation.

REMOTE CONTROLLER' S BATTERIES INSTALL

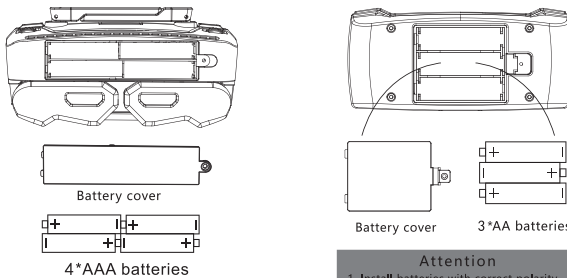

Attention
1. Install batteries with correct polarity
2. Do not mix old and new batteries
3. Do not mix different types of batteries

CHARGE BATTERIES OF QUADCOPTER

Push the switch of OFF opition then open the battery cover.
After disconnecting, connect port A to the computer's USB interface, the red light will be on, and the port B will be connected to the lithium battery. The red light will be on. The light is off when full. Charging time is around 180 minutes.

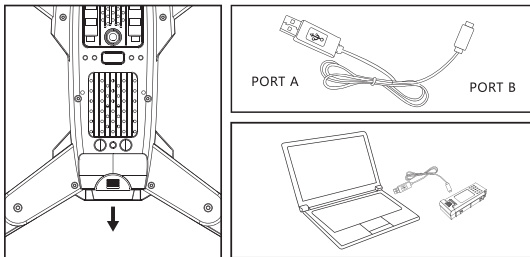

Attention :

1. Please stop charging when the plug is overheat due to over charge, or it may cause damages to the batteries.
2. Please supervise the charging process when charging.
3. Please make sure you use the original USD cable provided which is reliable balance charging mode to avoid an accident.
4. Please do not charge the batteries if the surface temperature is sitll not cool after flying, it is better to wait around 30 minutes until the temperature back to be normal.
5. Please do not throw the batteries into the file to cause accidents.
6. Please do not short the circuit the batteries, do not mix the batteries with some small metal parts, otherwise, it will cause accidents easily.
7. It needs to use the factory charging line when charging, And the charging line can only be charged on the computer, if the adapter is needed, please purchased it additionally, It is forbidden to select other adapter yourself. The charging shall be supervised by someone, otherwise, in case of any accident, the manufacturer shall not take any responsibility.

PREPARATORY FLIGHT ENVIRONMENT

Flight Environment



Indoor: spacious space away from obstacles, people or pets is preferred.



Outdoor: sunny, windy and sunny days are preferred.



Please keep the aircraft in line of sight during the flight and keep away from obstacles, high-voltage cables, trees and personnel.



Do not fly in extreme environments, such as hot, cold, strong wind or rainstorm.

PREPARE TO FLY

Make sure the propeller is installed correctly securely and the aircraft arms are straight.

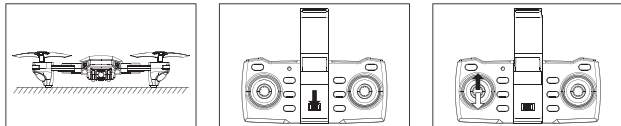

1. Turn on the power of the aircraft fuselage. Place the aircraft on a lever surface.
2. Open the remote control handle than turn on the power of the remote control and hear the "Di" sound is successful.
3. Push the left lever up and down to the bottom. and the indicator light is always on.

Take-off Method 1:

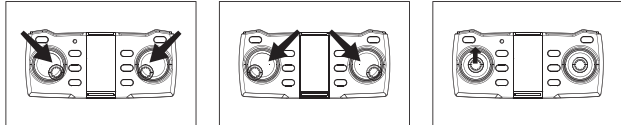

1. As shown in the fig, operating the right and left control lever to start calibration.
2. As shown in the fig, operating the right and left control lever to unlock aircraft.
3. Push the throttle lever up slowly, and the aircraft will take off.

Take-off Method 2:

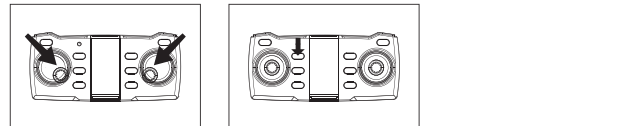

1. As shown in the fig, operating the right and left control lever to start calibration.
2. Short press one key take-off/landing button, the aircraft will take-off.

Landing Method 1:

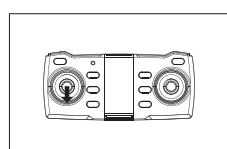

1. Push the throttle lever down slowly, until the aircraft lands. Keep the throttle lever at the lowest position, aircraft lands, the motor stops and the aircraft lands successfully.

Landing Method 2:

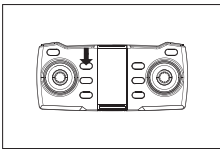

1. Short press one key take-off/landing button, the aircraft will landing.

OPERATING DIRECTION

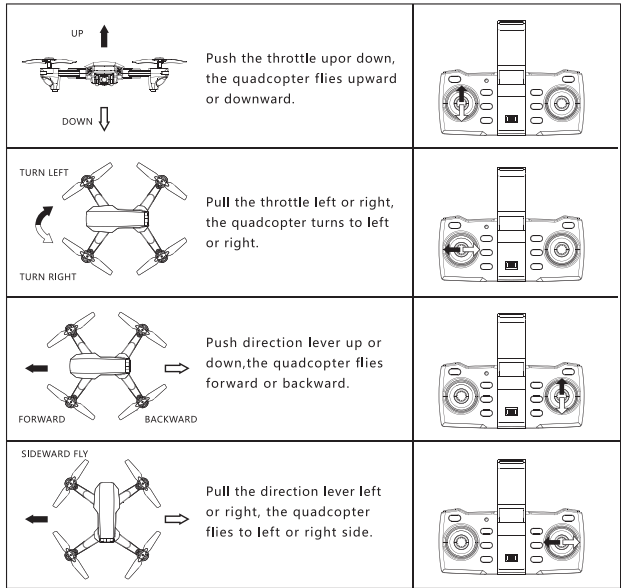

SPECIAL NOTICE

Without any operated of the control lever, the quadcopter keeps rotating in the sky, you can correct it by pressing the button of "fine-tuning" .

When the aircraft from the groud is around 30cm, the flight will be affected by the aircraft itself as the blades rotating, we call this as "Ground Reaction", the effective will be more strong when the aircraft get more close to the ground.

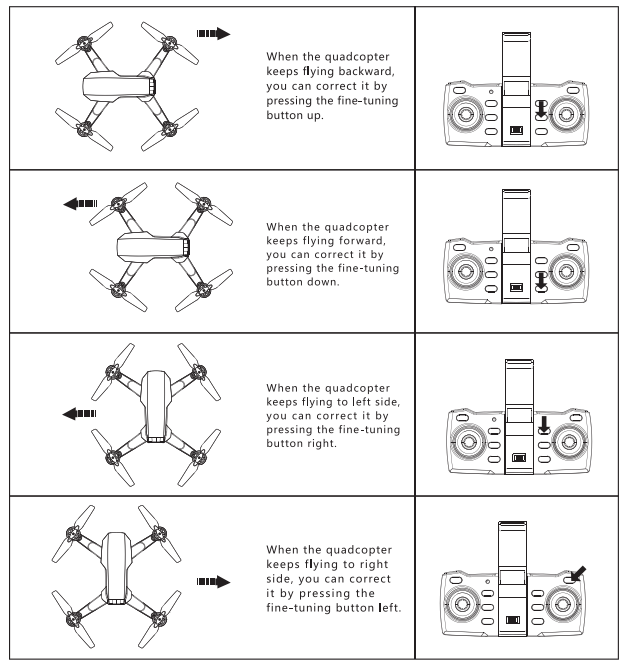

FLYING EXERCISES

Try some exercise after familiar with some basic learning.

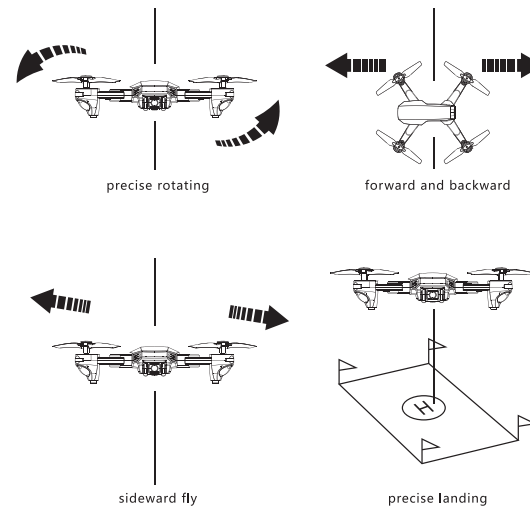

HEADLESS FUNCTION

1. Switch to headless function:
After frequency modulation of the aircraft with the remote controller, long press down headless function switch on the top left of the controller, remote controller will give out, "Di" and the indicator light is flashing from long bright state, it means that it enter into headless state.
2. Exit headless function :
After enter into headless state, long press down the headless function switch and hearing "Di", and the indicator light is into long bright state from flashing, it means that it exits headless state.
3. Correcting forward direction:
After aircraft crashes into headless state, it needs to adjust the aircraft' s direction, that means when the aircraft start frequency modulation, the direction of the indicator light on the aircraft means the correct direction that aircraft moves on.
4. One key return :
Under headless state, press" one key return" , the aircraft will fly to the player, when you press again, it will exit to the normal playing.

PROBLEMS AND SOLUTIONS

problems	causes	solutions
Power off of the remote controller	1 The switch is on the position of "OFF"	1 Move to the position of "ON"
	2 Batteries in wrong polarity	2 Checking and correct the polarity of batteries
	3 Power off	3 Checking and change the new batteries
Remote controller has no response	1 No turning on the energy	1 Move to the position of "ON"
	2 No connecting the aircraft' s batteries	2 Checking and correct connect the power on
	3 Strong wind	3 Please play indoors where is spacious.
Aircraft can not be up	1 Rotor speed is too low	1 Push up the accelerator
	2 The aircraft' s power is not enough	2 Please make the aircraft' s batteries fully charged
Out of control	Accelerator operated no return the aircraft upward	when you do the frequency modulation, the accelerator operated should be back to the original position
	Out of the control distance	Please play within the effective distance
Excessive landing	The speed of accelerator pulling is too fast.	Please pull the control lever slowly, maintain a smooth landing.

ATTENTION

1. The control distance will be effected by the low battery.
2. It is hard to fly or height is not enough when the batteries energy is low.
3. If there is any damages occurred, please stop playing and take it to be repaired to avoid accidents.
4. Please remove the batteries from the remote controller if long time not used to protect from batteries leakage
5. To avoid the quadcopter from high falling or collision each other.
6. If there is any problem occurred during using, please replace our factory's original parts, or it may cause the damages easily.

PARTS SHOW

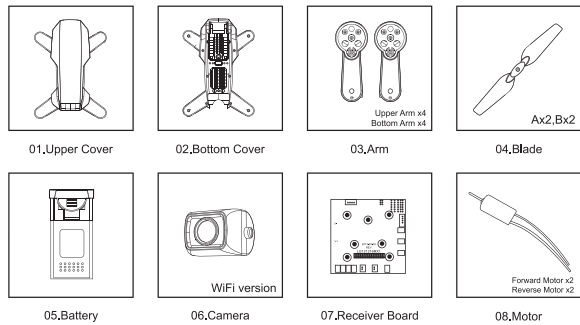

Dagger model is a drone without GPS function. Therefore some functions specified in this manual may differ from the purchased model.
Some of these functions are as follows "Optical Flow", "Intelligent Image Tracking", "Video Tracking", "One Key Return".

Specifications and images are subject to change without notice.

