

● **BLAUPUNKT**

CAR DAMPING SHEET DAMP 2000

Where to Install...

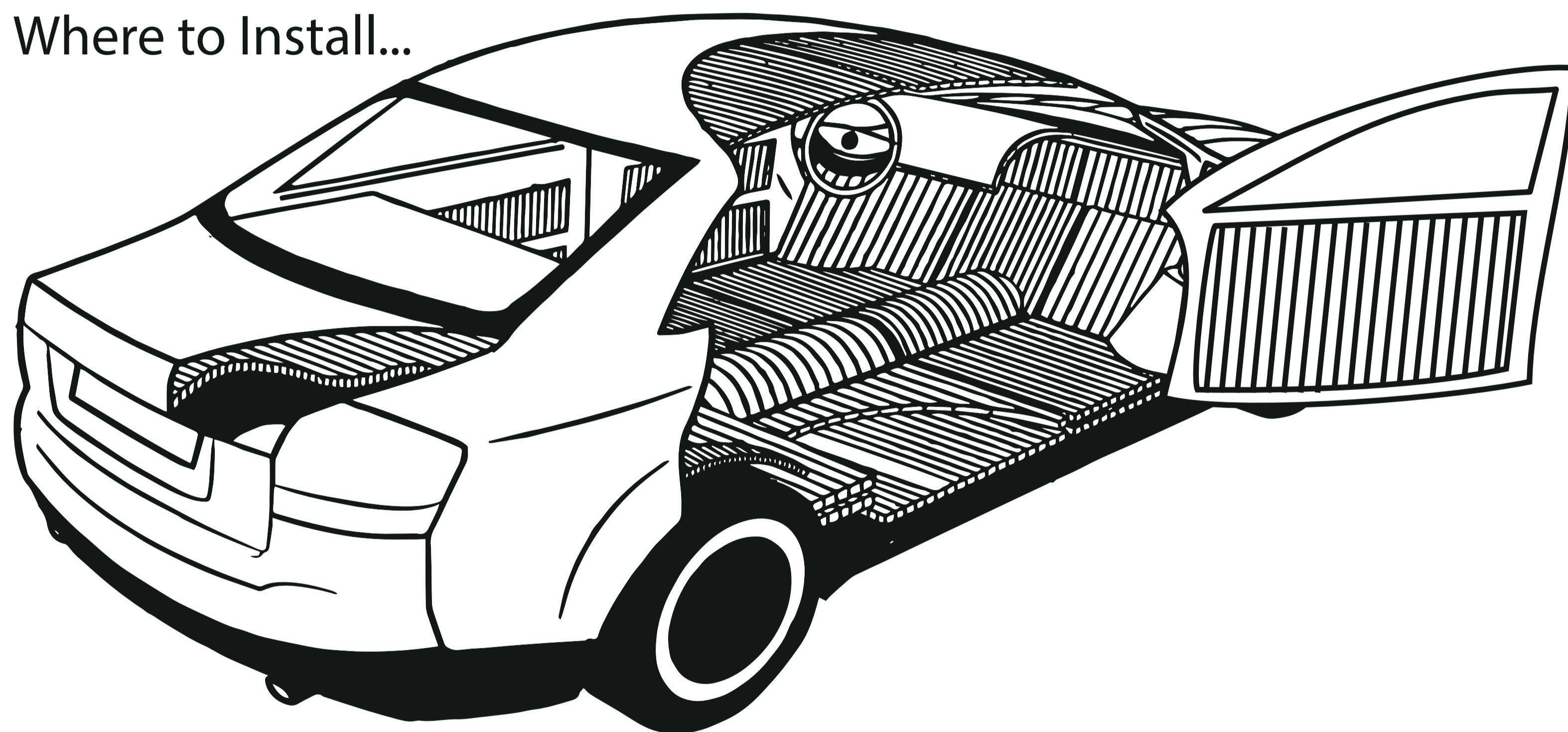

Thickness – 1.9 mm | Size – 800mm x 460mm | Coverage Area – 3.96 sqft

Get Better Sound - Hear More Music - Get Better Bass

Blaupunkt DAMP 2000 is a super sticky butyl rubber bonded to an aluminum alloy skin. It is very simple to cut and install. The butyl rubber and heavy aluminum alloy skin will stick and contour better than any other product in the market without tearing. It will conform easily to all interior surfaces, and the sticky butyl rubber will adhere to a surface and stay in place without any special surface prep, and without leaving any odor or dripping material.

Make any **SPEAKER** **SOUND BETTER!**

How to sound insulate your car

1

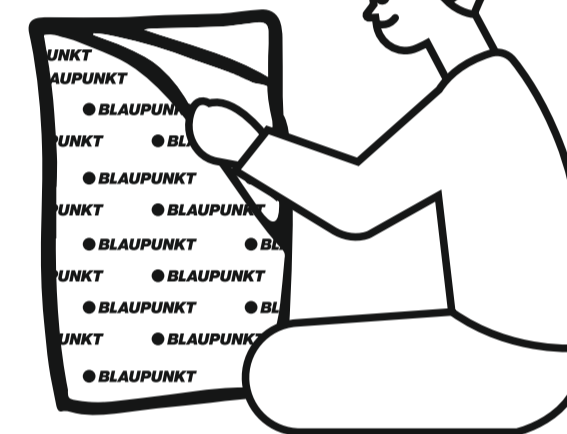

2

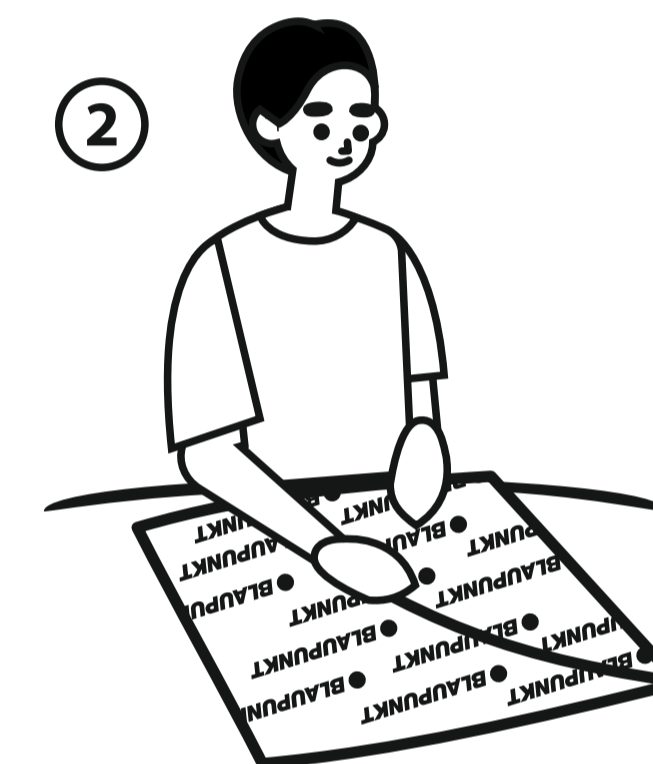

3

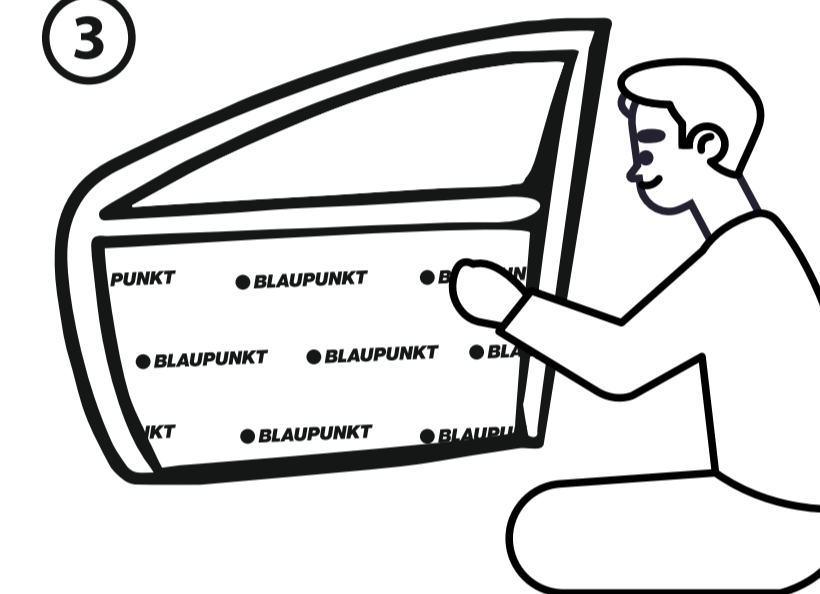

Step 1: Remove door pads to provide access to install DAMP 2000.

Step 2: Clean the sheet metal surface area of the door skin preferably with acetone to ensure the butyl rubber sticks properly or use an appropriate cleaning agent such as rubbing alcohol and a rag to clean the sheet metal surface.

Step 3: Take measurements. Measure the door sheet metal panels and floor to install the dampening sheet - DAMP 2000.

Step 4: Cut the dampening sheet to the desired sizes using a sharp utility knife.

Step 5: Stick the dampening sheet to the sheet metal panels. This will help reduce vibrations caused by the speaker by adding mass to the thin sheet metal panels.

Step 6: Press the dampening sheet in place. When applying the material, start with the innermost sections and around holes. Simply peel off a protective layer to reveal the butyl rubber bonded side. Once you apply the material, use a roller on the aluminium alloy side while applying some pressure to make it stick firmly. This will also remove air bubbles.

Step 7: Use the roller to remove any lumps in the insulation.

Step 8: Allow time to dry. Allow the materials to dry in place before proceeding.

Step 9: Put back all door pads and check for panel vibration caused by speakers.