

75" SMART INTERACTIVE WHITEBOARD DISPLAY

BP-IWB-75CAM

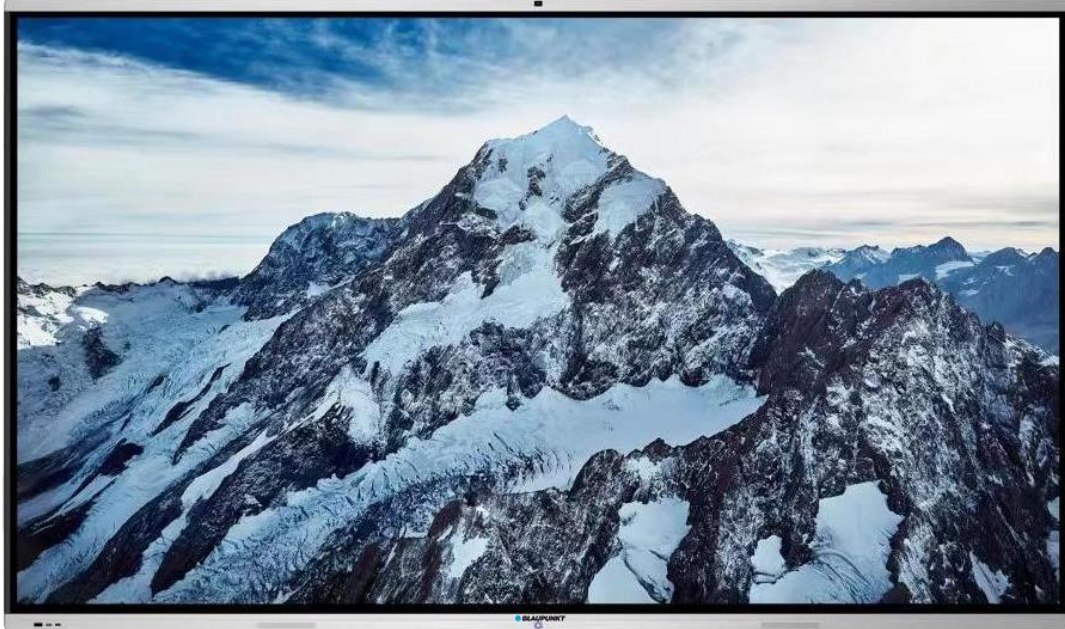

FEATURES

- Aluminum alloy frame, surface sandblasted and anodized, iron shell back cover, active heat dissipation; 4mm physically tempered vandal-proof high-transparency glass; enhances visual effects and enhances touch experience;
- High-speed 20-point infrared touch, faster writing speed, best writing experience;
- Ultra-narrow sandblasted face frame, ultra-narrow design, the entire machine face frame is only 22MM on one side.
- Using the international standard OPS slot, the integrated plug-in design makes it easy to upgrade and maintain. There are no visible computer module connection lines on the outside, and the body is beautiful;
- Front-mounted expansion port: 2-way PC-USB is convenient for users to expand and use.
- The front one-button start switch realizes the three-in-one TV, computer, and energy-saving integrated switch functions; it is easy to operate and has a simple and elegant appearance.
- The front remote-control window is convenient for users to operate with remote control and set up and debug the machine.
- The speaker has a front sound outlet, a honeycomb sound hole, and a mesh diameter of 1.2mm with a mesh density of 1488 to prevent sound effects caused by the built-in environment.
- The Android motherboard and PC in the machine have built-in WIFI modules respectively, which facilitates users to conduct wireless transmission and network operations through WIFI.
- Support side-pull touch menu, support any channel writing, annotation, and screenshot functions; child lock function, key functions can be blocked through settings.

PRODUCT PARAMETERS

Specification	
Product model	BP-IWB-75CAM
Screen size	75 inches
Bare metal size	1707.16 (length) x 1012.72 (height) x 92.0 (thickness) mm
Package Size	1847 (length) x1185 (height) x205 (thickness) mm
Backlight	DLED backlight
Resolution	3840*2160
Brightness (cd/m ²)	350
Contrast Ratio	1200:1
Response Time (ms)	6.5
Display color	8 bit/16.7 billion
Viewing Angle	178°
Energy saving	Support low power consumption mode and standby mode
Standby power	≤0.5W (actual standby power is related to the power supply)
Dressing filter	3D
Dynamic compensation	3D
Noise reduction	Support
Key Function	Three-in-one power switch (full function remote control)
Machine power consumption	≤650W
Operating Voltage	100V ~ 240VAC, 50/60Hz
Speaker	8Ω10W*2
Net weight / Gross weight	Estimated 85/95KG
System description	
CPU	Amlogic T982 Quad Core Cortex-A55 and Mali G52
CPU Frequency	1.9GHz
RAM/ROM	DDR4: 4GB eMMC: 32GB
System Compatibility	Android 11.0
Input port	
HDMI	HDMI*2
USB	USB3.0 *1+USB2.0 *1
RS232	D-SUB*1
RJ45	Network port terminal input*1
CVBS	Earphone terminals*2
Output port	
Headphone output	Earphone terminals*1
Coaxial output	RCA*1
CVBS output	Earphone terminals (black)*1

WiFi / Bluetooth	
WiFi Configuration	Wi-Fi 5, supports 5G/2.4G
WiFi Performance	30m ² coverage, 20m transmission distance in open space
Bluetooth Version	5.0
Bluetooth Performance	12m transmission distance in open space
Touch description	
Touch points	WIN7 (Ultimate Edition) driver-free 20 points, Android driver 20 points
Touch Accuracy	±2mm
Response time	4ms ~ 12ms
Identifiable object	≥Φ5mm non-transparent objects
Transmittance	Tempered glass 90%
Temperature range	Working temperature: 0°C ~ 60°C
Operating Voltage	DC5V
Working power consumption	≥1W
Built-in camera and microphone parameters	
Image Sensor	HD CMOS sensor
Pixel	13 million pixels
Lens specifications	Wide angle fixed focus
Audio processor	The built-in microphone uses a quad-core digital processing chip
8 array microphones	Adopts DSP core, supports 6 analog/digital MIC inputs, and high-performance echo cancellation (AEC) function
Stereo output	High signal-to-noise ratio, low noise level 3uvrms, providing high-fidelity audio output

DIMENSIONS

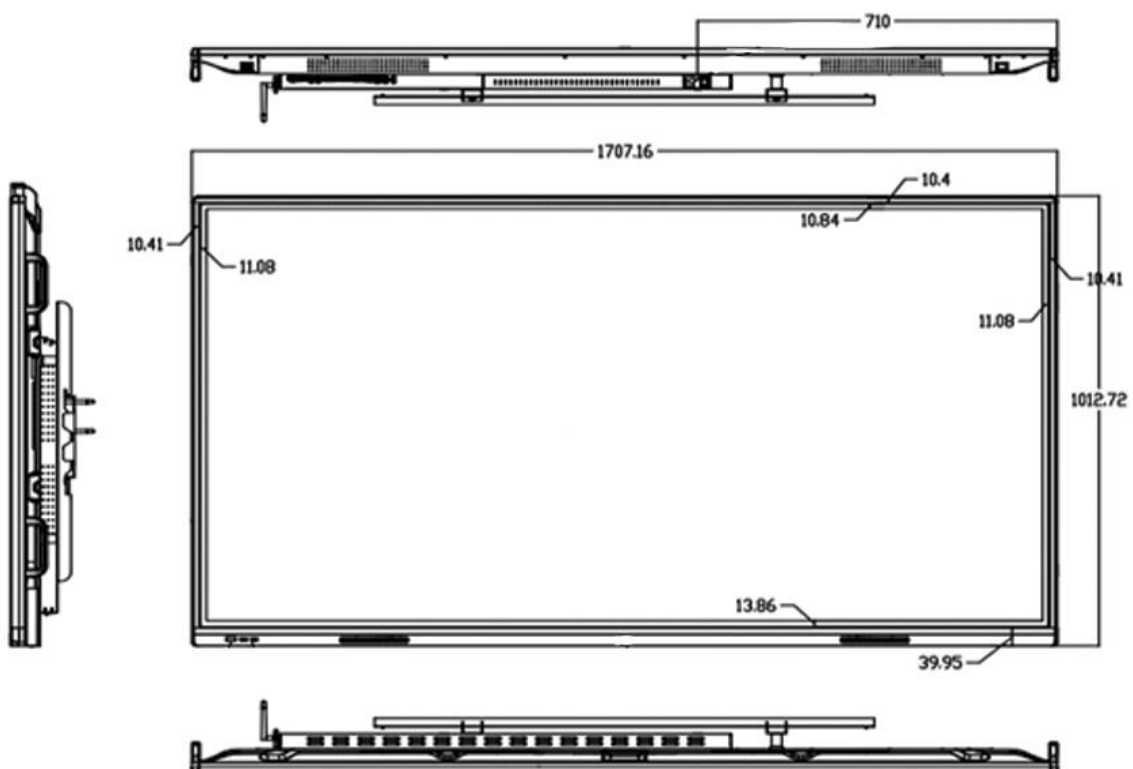

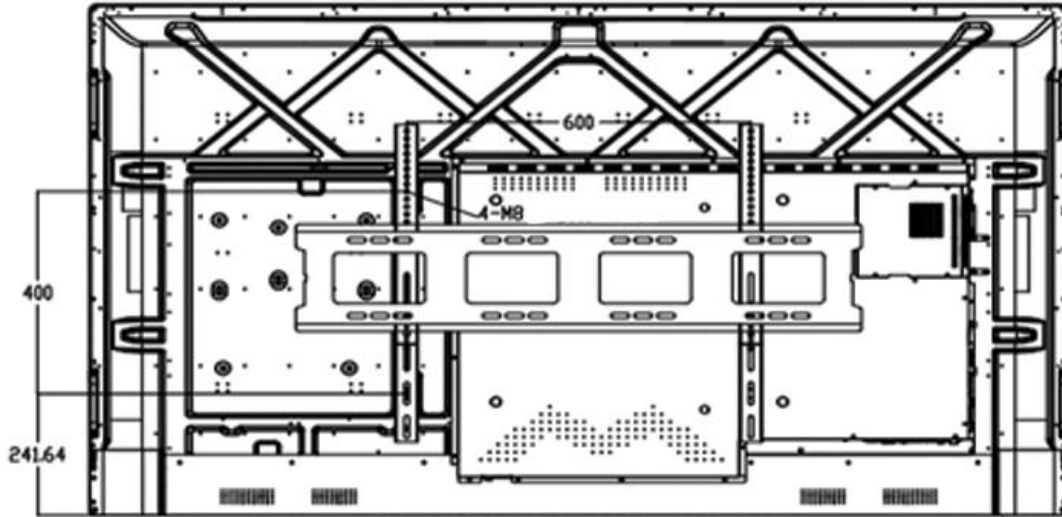

PREVIEW OF PHYSICAL EFFECTS



Meeting room:



Classroom:



Enjoy it.